



## TISSUE CULTURE AUTOMATIC FILLING MACHINE



● Model:GZJ-103

Size 1800×800×1200mm

Weight 135KG

Power 0.35KW 220VAC+PE 50Hz

Bottle height Up to 150mm

Capacity Up to 7,000 bottles/hour

Filling range Up to 500ml

Tissue culture frame 525×425×70mm

Filling object Tissue culture medium  
agar and other liquids



## PRODUCT CHARACTERISTICS



Filling Accuracy Up to  $\pm 1$  ml



Automatic Detection of Filling

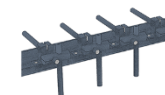

Uniform Flow Rate  
No Sputtering Bottle Mouth

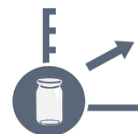

Filling Speed Up to  
7000 Bottles/Hour



Adjustable Sprinkler  
Suitable for Various Bottles



Optional Filling Channel Number  
and Liquid Heating Function



User-Friendly Interface



Low Maintenance



Self-Fault Detection  
Safe and Reliable

Dongguan Enzhuo Intelligent  
Technology Co.,Ltd.

🌐 [www.agriaiip.com](http://www.agriaiip.com)

☎ 0769-22893059

✉ [company@agriaiip.com](mailto:company@agriaiip.com)

📍 Room 105 and 106, Building 1, Gongye West Road No.12,  
Songshan Lake, Dongguan, Guangdong, China